

EMBERTON™



STROUD IRONING CENTRE STORE & SAFETY SYSTEM

GUEST ROOM



UNIQUE & PATENTED DESIGN

Sliding Frame Secure Iron for
complete ironing centre system



Stores Easily on
WARDROBE RAIL
Easy to Lift & Replace



Use as
**WALL MOUNTED IRON
& BOARD STORE**
with Tidy Cables



NEW GENERATION IRONING CENTRE STORE & SAFETY SYSTEM

Design Protected by
International Registered Designs
& Patents Pending
© Emberton Group Inc

info@emberton.com
www.emberton.com

STROUD IRONING CENTRE

SAFE. UNIQUE.
ROBUST. CONVENIENT



Design Protected by
International Registered Designs
& Patents Pending
© Emberton Group Inc

- Unique and Patented Design – sliding frame design secures iron
- Convenient, Easy and Safe – swivel, lift out & replace during ironing
- Universal Fitting - Suits and fits almost all iron types and sizes
- Protective Silicon Pad protects sole plate
- System Options – Ironing Centre or Iron Store



ANTI-THEFT CABLE LOCK
on Optional Iron Board
Mount Bracket

IRON BOARD HOLDER OPTIONS AVAILABLE

SUITS AND FITS YOUR IRON TYPES AND SIZES



290mm

206mm

Sliding sizes from
206mm to 290mm
(84mm Adjustment)

COMPARISON

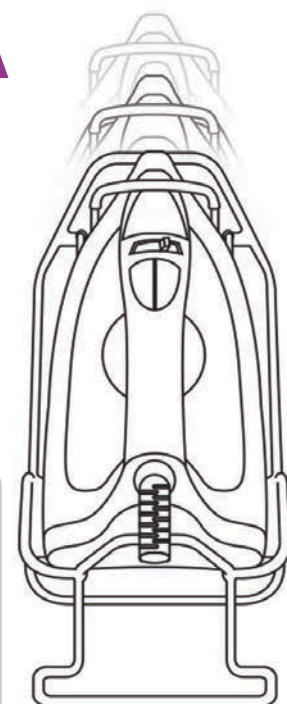
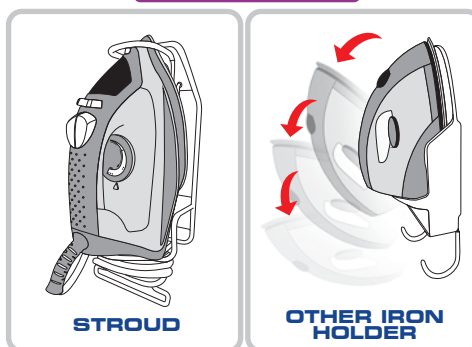

**ADJUSTABLE &
UNIVERSAL
FITTING**

STROUD IRON HOLDER
UNIVERSAL & SPACE EFFICIENT



PROTECTIVE SILICON PAD
to prevent sole plate damage and absorb heat

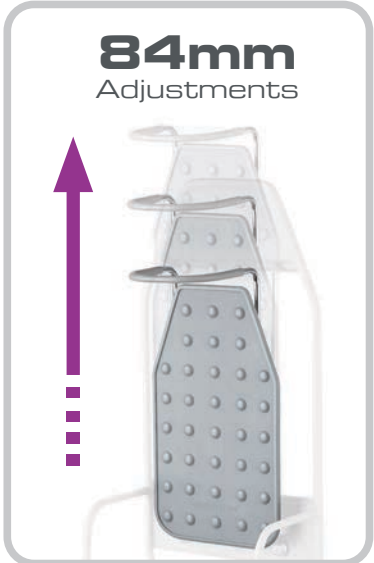

SLIDING FRAMES GLIDES
Universal - Fully adjustable to fit large and small irons



HOLDER ANGLE
matches iron shape for perfect fit



OPTIONAL HOLDER
for iron board set on combine



INTEGRATED CABLE WRAP
Cables may be neatly wrapped around frame



RAPID CABLE TIDY SLOT
Cables may be bundled and inserted to save time

SELECTION & CONFIGURATION SYSTEM COMPONENTS

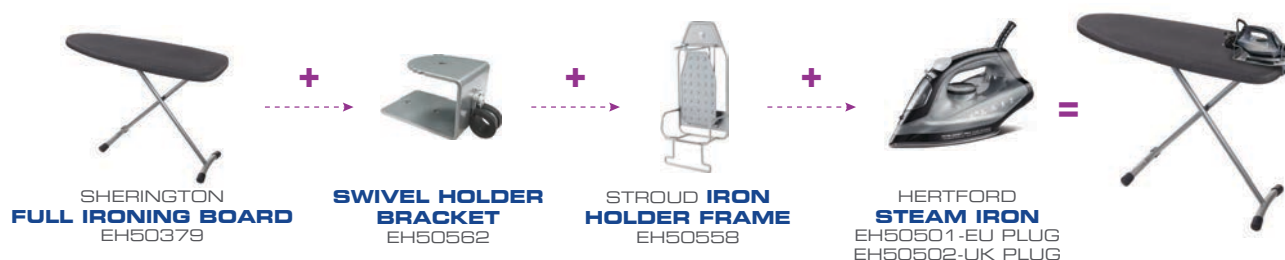

	PRODUCT RANGE	ART NO	
COMBO 1	STROUD IRONING CENTRE WITH FULL SIZE BOARD & HERTFORD STEAM IRON FULL SIZE IRONING BOARD - SHERINGTON 109 x 38 x 87cm STEAM IRON (BLACK) - HERTFORD 26.6 x 12 x 14cm	EH50586 (EU PLUG) EH50587 (UK PLUG)	
COMBO 2	STROUD IRONING CENTRE WITH COMPACT SIZE BOARD & HERTFORD STEAM IRON COMPACT SIZE IRONING BOARD - MOULTON 97 x 33 x 76cm STEAM IRON (BLACK) - HERTFORD 26.6 x 12 x 14cm	EH50590 (EU PLUG) EH50591 (UK PLUG)	
COMBO 3	STROUD IRONING CENTRE WITH FULL SIZE BOARD & YARDLEY DRY IRON FULL SIZE IRONING BOARD - SHERINGTON 109 x 38 x 87cm DRY IRON (BLACK) - YARDLEY 25.7 x 11.4 x 12.6cm	EH50588 (EU PLUG) EH50589 (UK PLUG)	
COMBO 4	STROUD IRONING CENTRE WITH COMPACT SIZE BOARD & YARDLEY DRY IRON COMPACT SIZE IRONING BOARD - MOULTON 97 x 33 x 76cm DRY IRON (BLACK) - YARDLEY 25.7 x 11.4 x 12.6cm	EH50592 (EU PLUG) EH50593 (UK PLUG)	

WALL FIX OPTIONS



IRON BOARD HOLDERS

- Stores ironing board efficiently in wardrobe or on wall
- Removable, anti-theft or wall mounted options available

OR CHOOSE FROM THE FOLLOWING IRON BOARD HOLDER OPTIONS AVAILABLE

HYDE IRONING BOARD WALL BRACKET	EH50508		SANDHURST UNIVERSAL IRON BOARD HOLDER SECURITY RAIL LOOP	EH50566		SANDHURST UNIVERSAL IRON BOARD HOLDER OPEN RAIL HOOK	EH50556	
---------------------------------------	---------	--	---	---------	--	---	---------	--



HYDE
WALL HOLDER



SANDHURST
CLOSE LOOP HOOK



SANDHURST
LIFT OFF HOOK

DRY & STEAM IRONS STEAM. EXPERT. SAFE. FAST. EFFICIENT



- DUAL SAFE – Thermostat and latest technology thermo-fuse for double safe circuit protection
- Durable, Safe & Elegant – Outstanding Ironing Performance & Quality



**YARDLEY
1200W DRY IRON**

UK PLUG : EH50549
EU PLUG : EH50548

- Motion Sensor Auto-Cut Off Safety – 30 Seconds unattended on soleplate and 5 minutes upright
- Dual Safe Thermostat & Latest Technology Internal Fuse
- ECO Auto Off Function for Energy Saving & Environmental Protection
- Overheat Safety Protection
- Cable cord guard tested to 20,000 cycles to ensure cable safety
- Generous 250 cm cord
- Tough Non-Stick Soleplate
- Narrow Front Tip – reaches confined areas
- Large Temperature Adjustment Dial
- Operating Light with Cut-Out Indicator
- Extra Safe Sealed Safety Plug
- Gloss Skirt with Attractive Black & Grey Design
- Contoured Grip Handle
- Available in EU & BS plug variants
- CE, CB, RoHS & GS Approved
- Plate size: 200mm x 110mm
- Power : AC 220-240V, 50/60Hz
- Weight : 745g



**HERTFORD BLACK
1600W STEAM IRON**

UK PLUG : EH50502
EU PLUG : EH50501

- Motion Sensor Auto-Cut Off Safety – 30 Seconds unattended on soleplate and 5 minutes upright
- Dual Safe Thermostat & Latest Technology Internal Fuse
- ECO Auto Off Function for Energy Saving & Environmental Protection
- Special Anti-drip feature to prevent water dripping through steam outlets after water cools
- Anti-calc to remove the limescale build up
- New water tank assembly method using wire frame and latest thermo-weld technology
- New thermostat series using silver coated technology ensuring much more accurate thermostat temperature dial match
- 250 ML Capacity water reservoir
- Cable cord guard tested to 20,000 cycles to ensure cable safety
- More powerful steam burst for improved ironing efficiency
- Non-Stick Soleplate
- Extra long 250cm cable
- LED Green & Red In-Use Indicator Light
- Auto Off Indicator Light
- Operating Light with Cut-Out Indicator
- CE, CB, RoHS & GS Approved
- UK or EU Plug variants
- 360° angle swivel cord
- Easy to use temperature/textile dial gauge
- Includes Refil Beaker
- Plate size: 206mm x 113mm
- Power : AC 220-240V, 50/60Hz



**HERTFORD WHITE
1600W STEAM IRON**

UK PLUG : EH50547
EU PLUG : EH50546



TOUGH IRONING BOARD ENGINEERED SERIES

- Rugged Tube Frame Legs 38mm/28mm
- Steam Flow Metal Mesh Top
- 2mm Foam & 5mm Felt Combination Padding
- Smooth Binding Edges to Withstand Fraying
- Cover Material : Cotton with Felt Underlay
- Cover Colour : Charcoal Grey
- Frame Colour : Silver Grey
- Maximum Height :
Full size - 87cm / Compact size - 76cm
- Board Dimensions :
Full size - 109cm x 38cm / Compact size - 97cm x 33cm



**REGULAR
IRONING BOARD**
with Fixed Metal
Iron Rest



RUGGED TUBE
Frame Legs
38mm/28mm

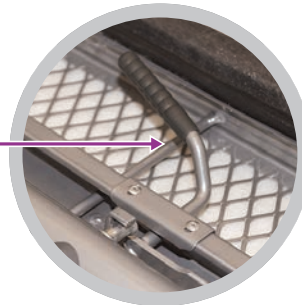

**STRONG DOUBLE
HANDLE**
Height Adjustment Lever

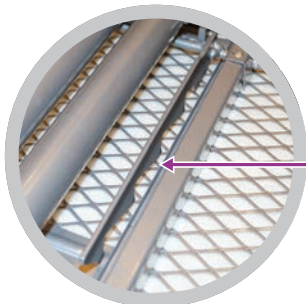

SUPER THICK
Height Adjustment Rail

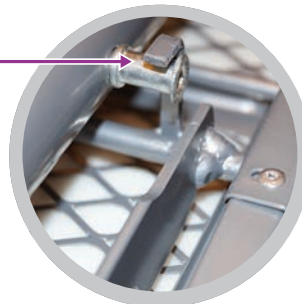

EXTRA THICK
Safety Lock

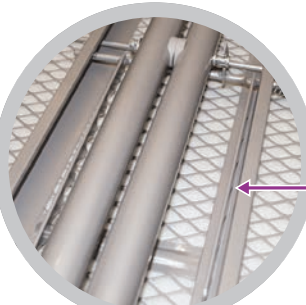

**EXTRA THICK
SUB-FRAME**
Structure



**HEAVY DUTY
ANGLE PROFILE**
Metal Components &
Robotic Welds

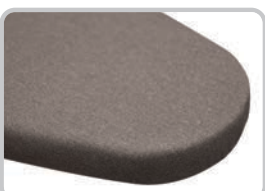

**METALLIC HEAT
REFLECTIVE**
Iron Board Cover



**SMOOTH BINDING
EDGES**
To Withstand Fraying



**2MM FOAM &
5MM FELT**
Combination Padding

IRONING BOARD FULL SIZE (Dimensions in CM)

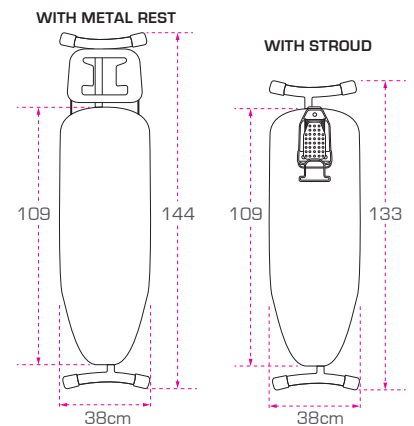

IRONING BOARD COMPACT SIZE (Dimensions in CM)

